

Planning Committee

Wednesday 13th October 2021

REDDITCH BOROUGH COUNCIL



*making
a
difference*

www.redditchbc.gov.uk

20/00863/FUL

Land off Ipsley Church Lane, Ipsley, Redditch

Change of use of land from open grassland to cemetery including burial of non-cremated and cremated remains. New vehicular access to Ipsley Church Lane.

Recommendation: delegate to grant subject to conditions and a legal agreement

Local Plan Policy designation

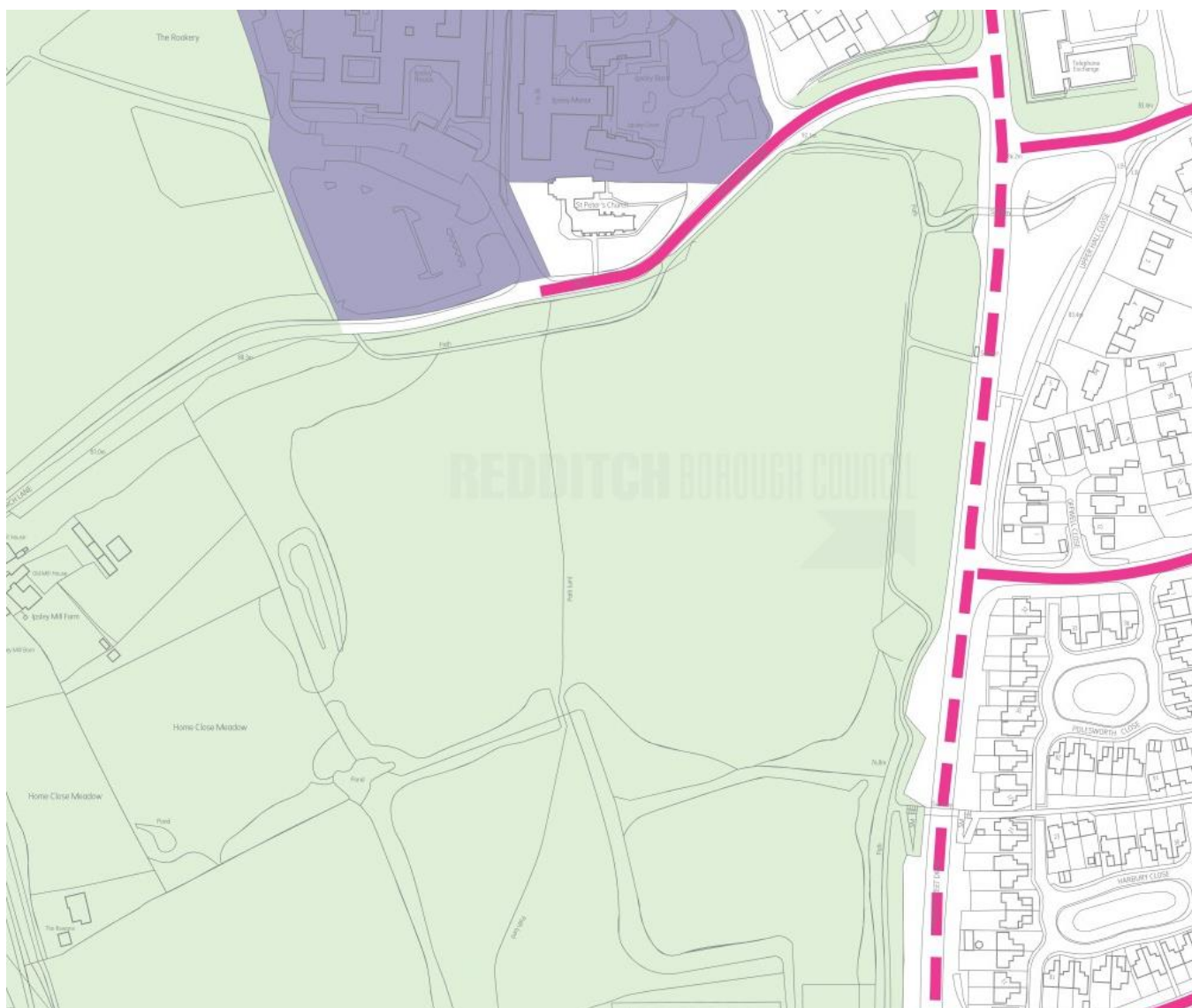

Primarily Open Space

Public rights of way location

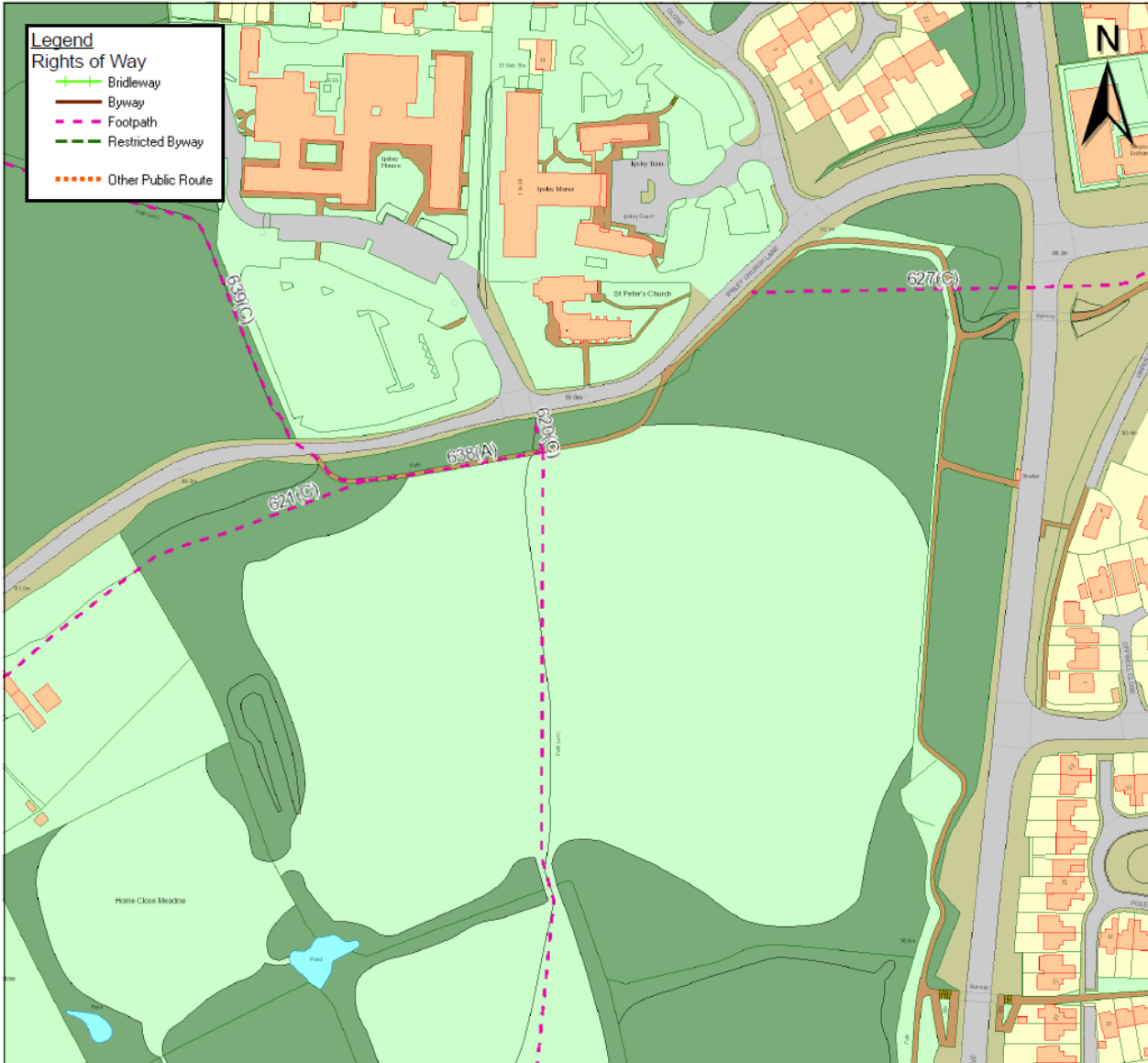

Aerial view



Satellite Images



Satellite Images



Satellite Images



Ickniel St Drive / Ipsley Church Lane junction



Ipsley Church Lane looking east



Ipsley Church Lane looking west



Existing footpath from Ipsley Church Lane



Inside site, view looking southwards



Inside site, view looking eastwards



Proposed access layout Rev E



Access detail

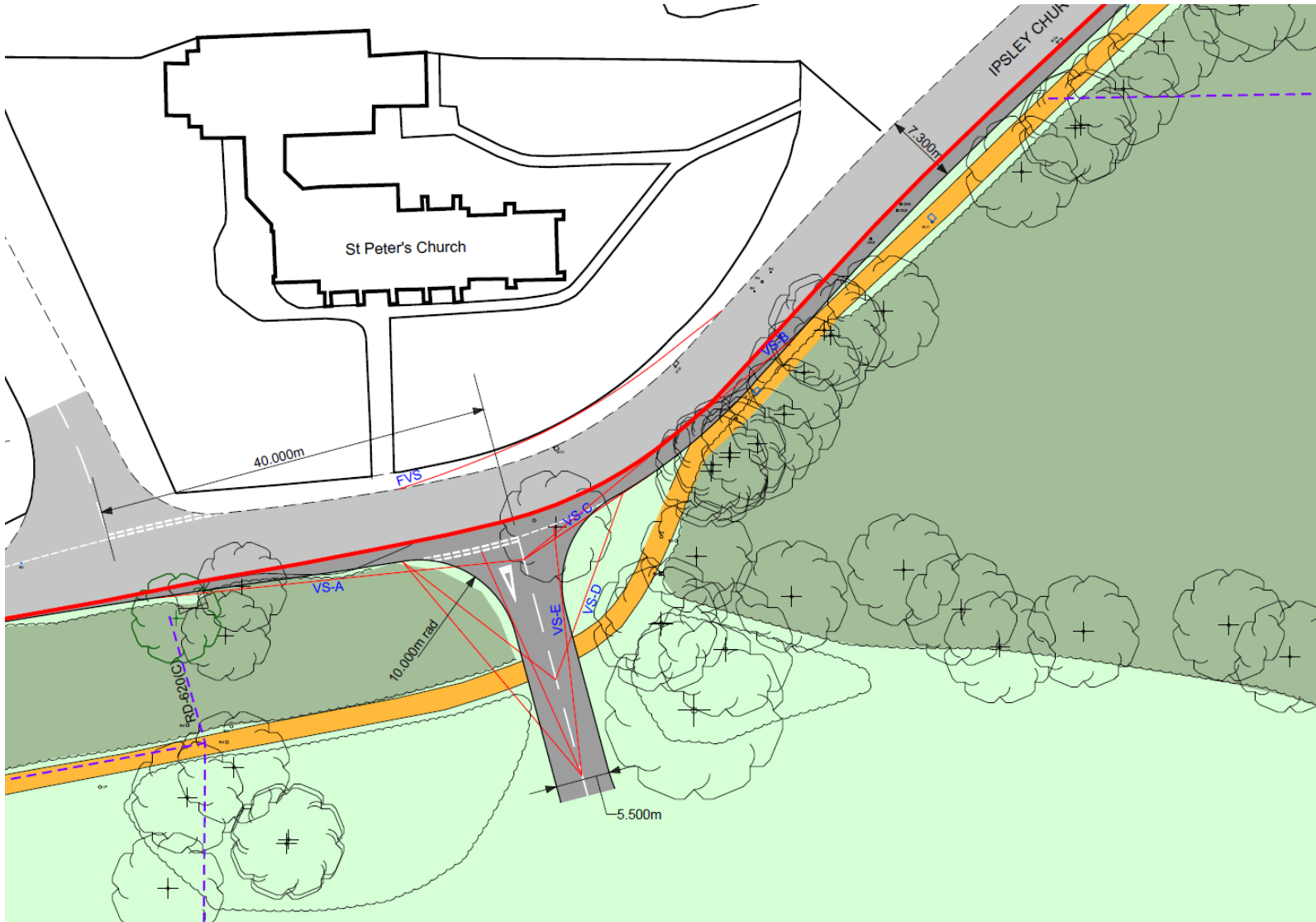

Conceptual landscape plan (indicative)

