

22/01265/FUL

30 Ansley Close, Matchborough East, Redditch B98 0AX

Change of use of highway land to private residential  
garden

Recommendation: grant subject to conditions

# Site Location

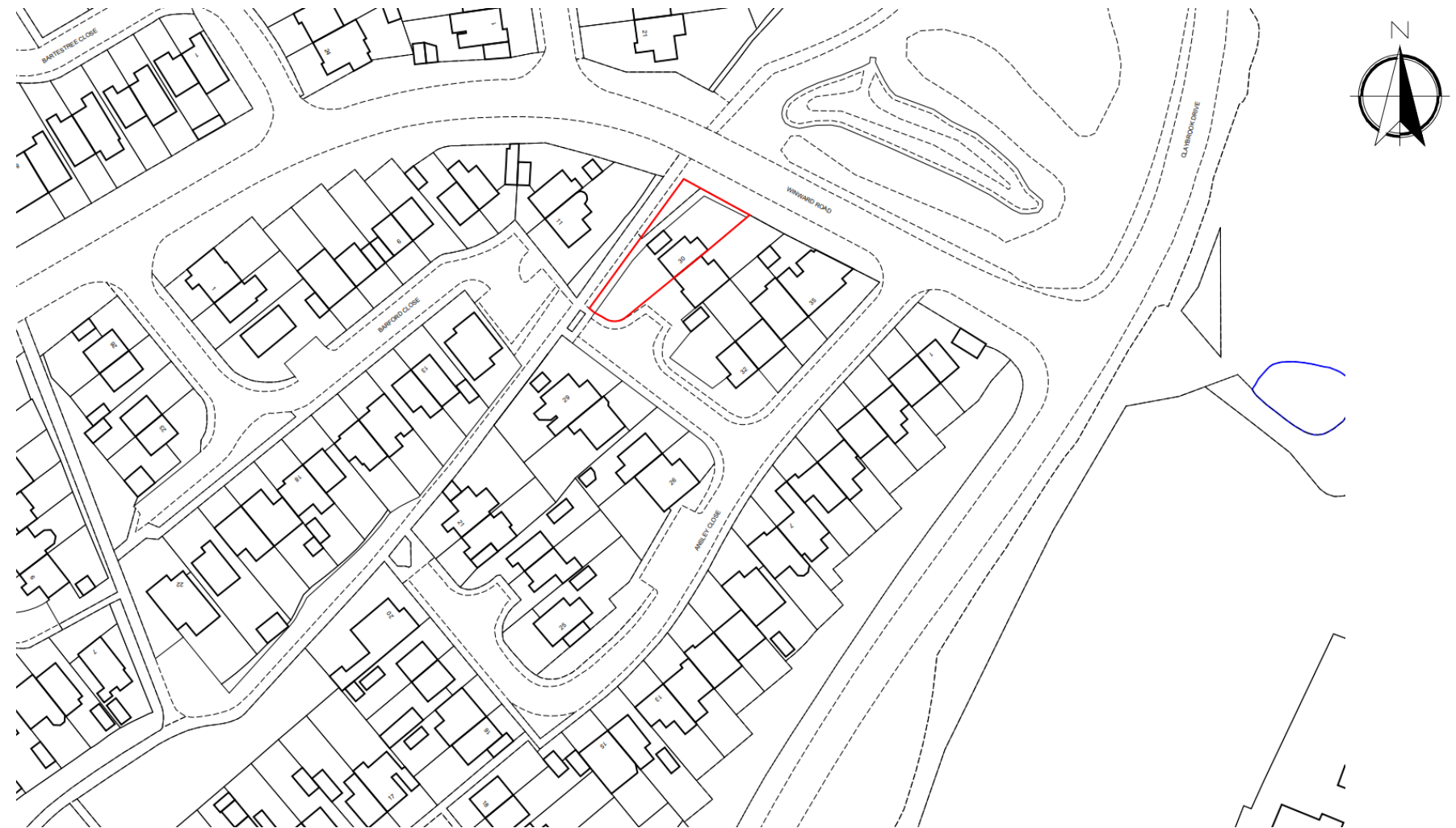

# Layout Plan



# Recent images

View of 30 Ansley Close



Existing footway





# Extract from BOR Local Plan 4 Policies map

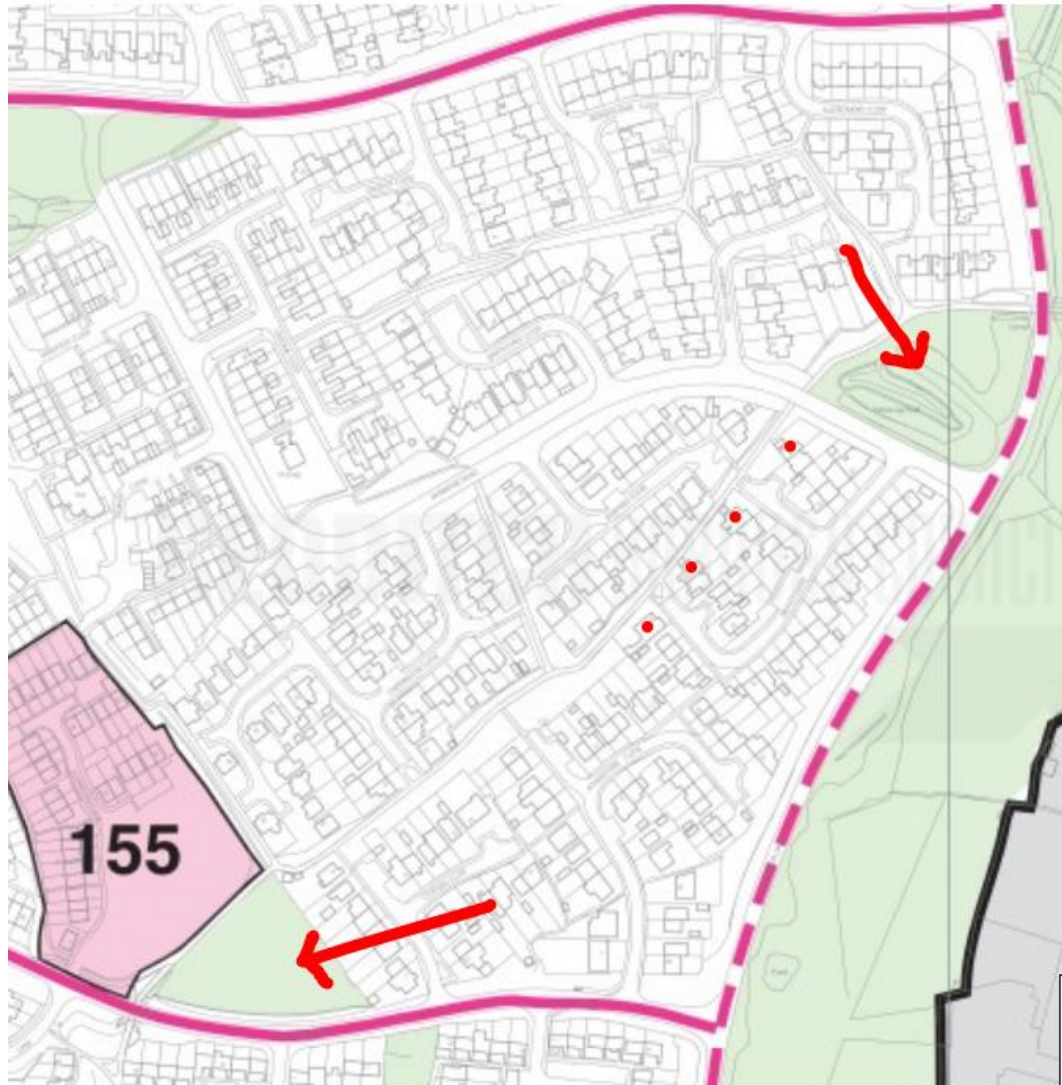

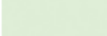
 Primarily Open Space

Arrows indicate Primarily Open Space referred to within report

Red dots indicate numbers 20, 21, 29, 30 Ansley Close