

22/01363/FUL

20 Ansley Close, Matchborough East, Redditch B98 0AX

Change of use of highway land to private residential
garden

Recommendation: grant subject to conditions

Site Location

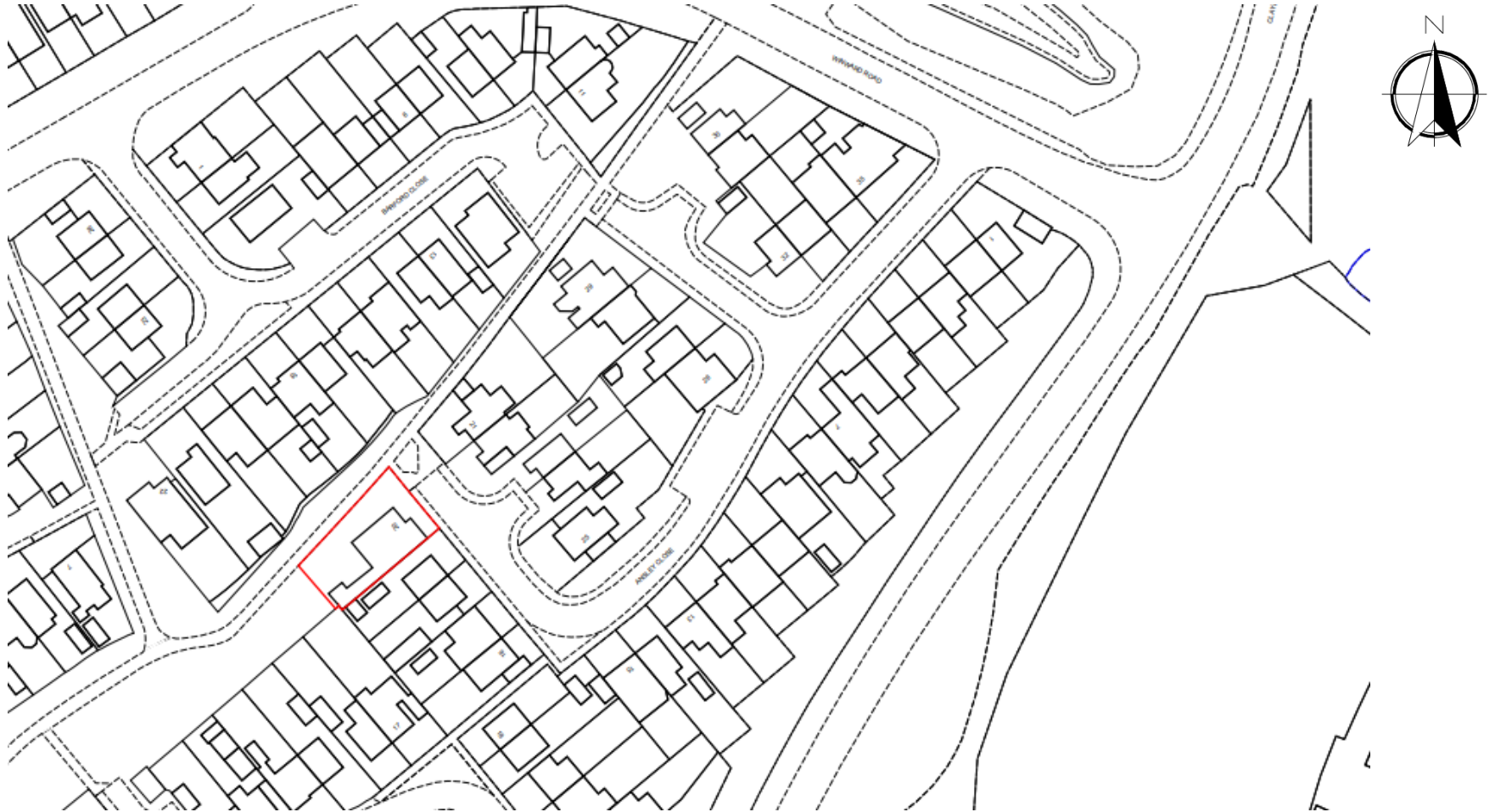

Layout Plan

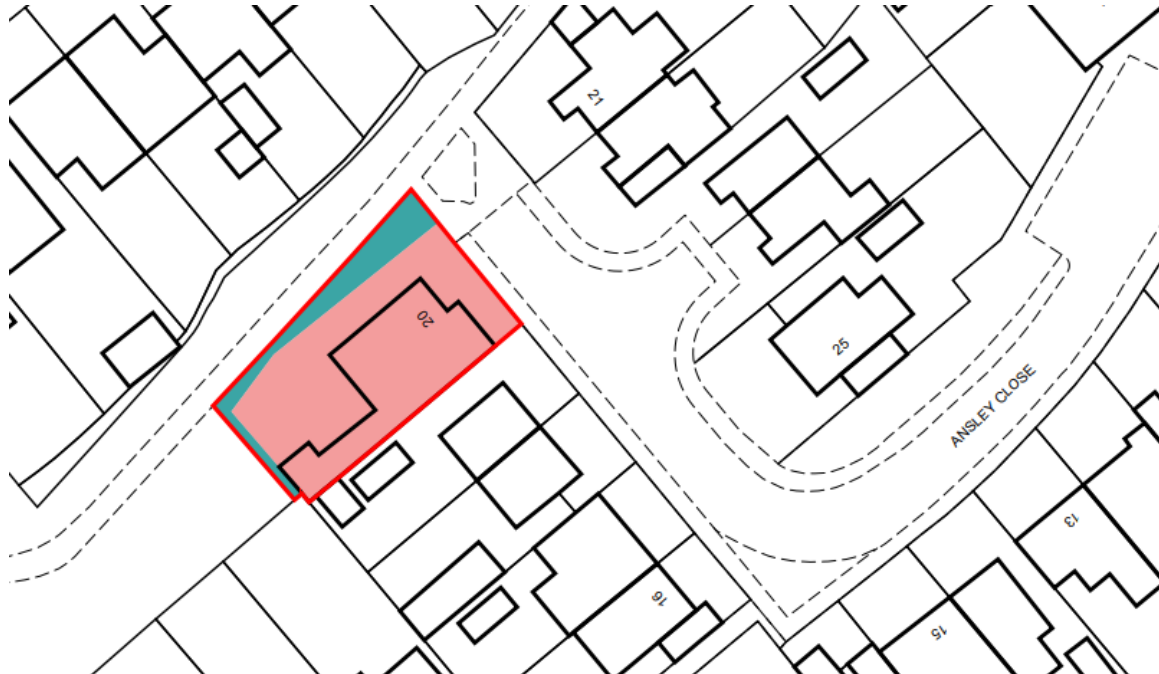

Key



Extent of Highway verge for
change of use to private garden,
and then formally Stopped Up



Existing Title area for No.20,
as shown by Land Registry

No.20 looking South. Fencing marked with arrow



Further images



Extract from BOR Local Plan 4 Policies map

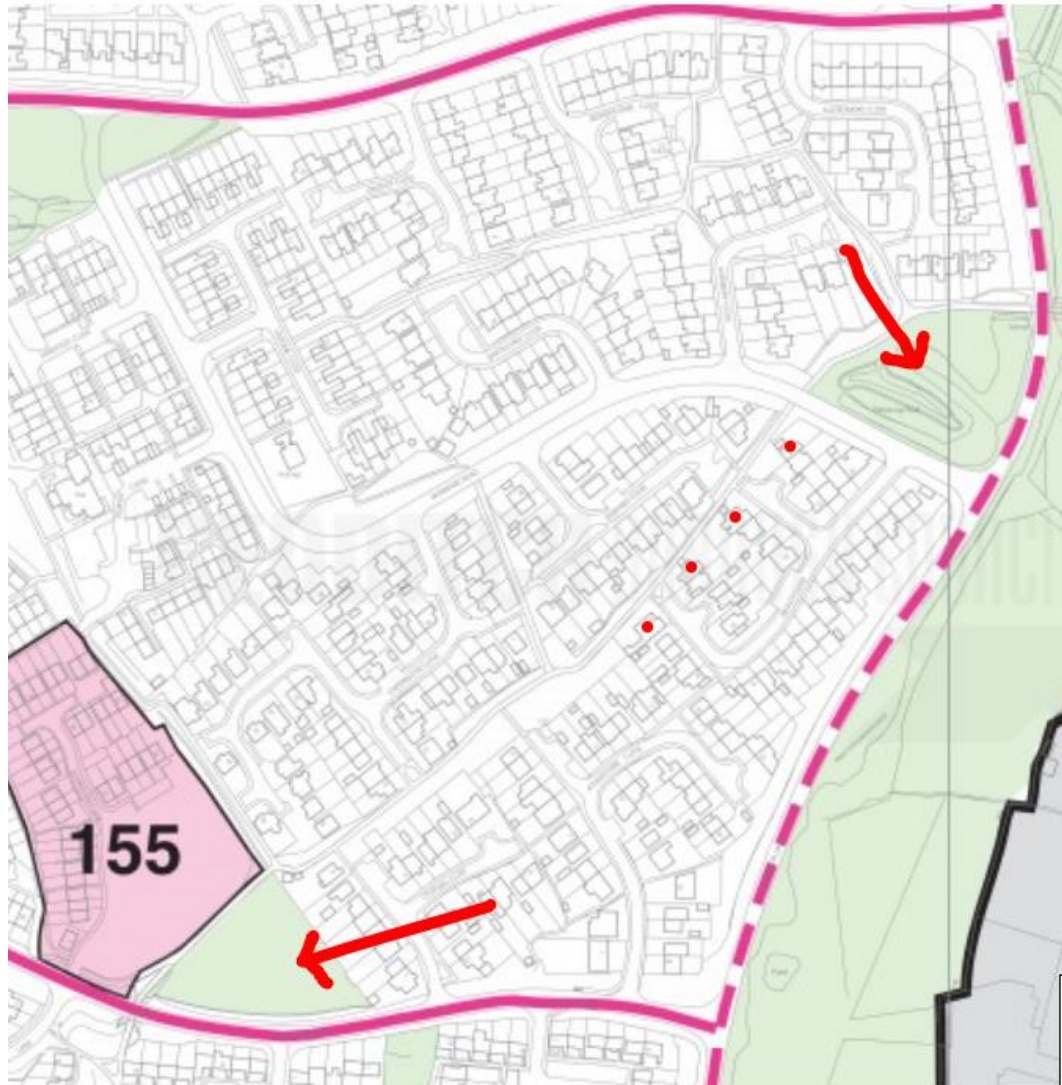

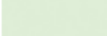
 Primarily Open Space

Arrows indicate Primarily Open Space referred to within report

Red dots indicate numbers 20, 21, 29, 30 Ansley Close

Prior to retrospective works and as proposed



Original Layout Prior to Retrospective Works

Key

Extent of existing adopted highway boundary (footpath and verge)



Existing Title area for properties, as shown by Land Registry



Layout as Proposed under Planning Application

Key

Revised extent of adopted highway boundary (footpath and verge) following Stopping Up Order



Revised Title area for properties, following Stopping Up Order